

| | |
|--------|-------------------------------|
| GROUP: | 17 |
| FORM: | 8AR |
| FILE: | Alternator Parts List Section |
| DATE: | November, 1994 |

| MODEL | VOLTS | AMPS |
|-------------------------|-------|------|
| Various See Table | | |

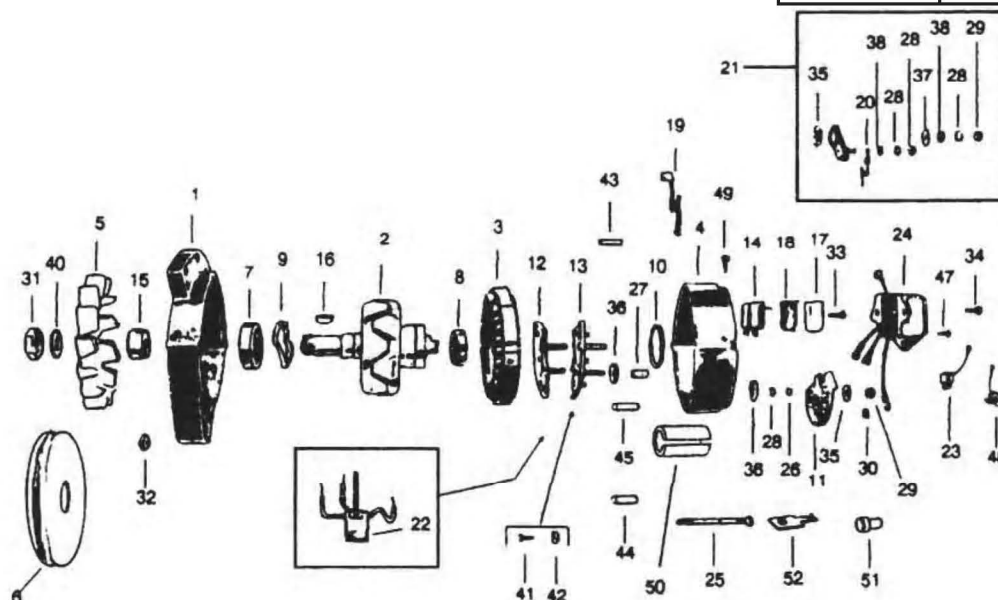

| MODEL NO. | SALES NO. | 1 HSNG FRONT | 2 ROTOR ASSEM | 3 STATOR ASSEM | 4 HSNG REAR | 5 FAN | 6 PULLEY | 7 BRNG FRONT | 8 BRNG REAR | 9 FR. BRNG RET | 10 R. BRNG RET | 11 DIODE ISOLATION | 12 DIODE REC.NEG. |
|-----------|-----------|--------------------|---------------------|----------------------|-------------------|----------|-------------|--------------------|-------------------|----------------------|----------------------|--------------------------|-------------------------|
| 8AR2001 | | 114-1 | 112-1 | 113-1 | 114-18 | 107-8 | | 111-21 | 111-23 | 111-3 | 111-25 | 101-30 | 101-2 |
| 8AR2002 | | 114-6 | 112-1 | 113-1 | 114-18 | 107-8 | | 111-21 | 111-23 | 111-3 | 111-25 | 101-30 | 101-2 |
| 8AR2004 | 110-100 | 114-6 | 112-1 | 113-1 | 114-18 | 107-8 | | 111-21 | 111-23 | 111-3 | 111-25 | 101-30 | 101-2 |
| 8AR2005 | | 114-6 | 112-1 | 113-1 | 114-18 | 107-8 | 107-1 | 111-21 | 111-23 | 111-3 | 111-25 | 101-30 | 101-2 |
| 8AR2006 | | 114-50 | 112-1 | 113-1 | 114-66 | 107-8 | 107-13 | 111-21 | 111-23 | 111-3 | 111-25 | 101-30 | 101-2 |
| 8AR2007 | 110-192 | 114-1 | 112-2 | 113-19 | 114-18 | 107-8 | | 111-21 | 111-23 | 111-3 | 111-25 | 101-44 | 101-2 |
| 8AR2008 | | 114-6 | 112-2 | 113-2 | 114-18 | 107-8 | | 111-21 | 111-23 | 111-3 | 111-25 | 101-30 | 101-2 |
| 8AR2009 | | 114-1 | 112-2 | 113-2 | 114-18 | 107-8 | | 111-21 | 111-23 | 111-3 | 111-25 | 101-30 | 101-2 |
| 8AR2012K | | 114-50 | 112-2 | 113-19 | 114-66 | 107-8 | | 111-21 | 111-23 | 111-3 | 111-25 | 101-30 | 101-2 |
| 8AR2013F | | 114-50 | 112-2 | 113-1 | 114-66 | 107-8 | | 111-21 | 111-23 | 111-3 | 111-25 | 101-44 | 101-2 |
| 8AR2013L | 110-476 | 114-6 | 112-90 | 113-71 | 114-98 | 107-114 | 107-5 | 26853 | 111-23 | 111-3 | 111-25 | | 101-236 |
| 8AR2014G | | 114-1 | 112-2 | 113-2 | 114-18 | 107-8 | | 111-21 | 111-23 | 111-3 | 111-25 | 101-44 | 101-2 |
| 8AR2015K | | 114-6 | 112-2 | 113-19 | 114-18 | 107-8 | | 111-21 | 111-23 | 111-3 | 111-25 | 101-30 | 101-2 |
| 8AR2016K | 110-147 | 114-6 | 112-2 | 113-19 | 114-18 | 107-8 | | 111-21 | 111-23 | 111-3 | 111-25 | 101-30 | 101-2 |
| 8AR2017F | | 114-1 | 112-1 | 113-1 | 114-18 | 107-8 | | 111-21 | 111-23 | 111-3 | 111-25 | 101-30 | 101-2 |
| 8AR2018F | 110-155 | 114-1 | 112-1 | 113-1 | 114-18 | 107-8 | | 111-21 | 111-23 | 111-3 | 111-25 | 101-30 | 101-2 |
| 8AR2019F | 110-146 | 114-50 | 112-1 | 113-1 | 114-66 | 107-8 | 107-43 | 111-21 | 111-23 | 111-3 | 111-25 | 101-44 | 101-2 |
| 8AR2021K | 110-178 | 114-6 | 112-2 | 113-19 | 114-98 | 107-8 | | 111-21 | 111-23 | 111-3 | 111-25 | | 101-126 |
| 8AR2022F | | 114-1 | 112-1 | 113-1 | 114-18 | 107-8 | | 111-21 | 111-23 | 111-3 | 111-25 | 101-30 | 101-2 |
| 8AR2023K | | 114-114 | 112-2 | 113-19 | 114-18 | 107-8 | | 111-21 | 111-23 | 111-3 | 111-25 | 101-30 | 101-2 |
| 8AR2024F | 110-161 | 114-1 | 112-1 | 113-1 | 114-18 | 107-68 | | 111-21 | 111-23 | 111-3 | 111-25 | 101-30 | 101-2 |
| 8AR2025K | 110-194 | 114-50 | 112-2 | 113-19 | 114-66 | 107-68 | 107-13 | 111-21 | 111-23 | 111-3 | 111-25 | 101-30 | 101-2 |
| 8AR2026F | 110-177 | 114-1 | 112-1 | 113-1 | 114-104 | 107-8 | 107-1 | 111-21 | 111-23 | 111-3 | 111-25 | | 101-2 |
| 8AR2028F | | 114-6 | 112-1 | 113-1 | 114-104 | 107-8 | | 111-21 | 111-23 | 111-3 | 111-25 | | 101-2 |
| 8AR2033F | | 114-1 | 112-1 | 113-1 | 114-18 | 107-8 | 107-5 | 111-21 | 111-23 | 111-3 | 111-25 | 101-30 | 101-2 |
| 8AR2037F | | 114-1 | 112-1 | 113-1 | 114-18 | 107-68 | | 111-21 | 111-23 | 111-3 | 111-25 | 101-30 | 101-2 |
| 8AR2041F | | 114-1 | 112-1 | 113-1 | 114-18 | 107-8 | 107-37 | 111-21 | 111-23 | 111-3 | 111-25 | 101-30 | 101-2 |
| 8AR2043F | | 114-93 | 112-1 | 113-1 | 114-104 | 107-68 | | 111-21 | 111-23 | 111-3 | 111-25 | | 101-2 |

Important: The information contained in this bulletin is intended for use by trained, professional technicians who have the proper tools, equipment, and training to perform the required maintenance described above. This information is NOT intended for 'do-it-yourselfers', and you should not assume that this information applies to your equipment. If you have any questions regarding this information please visit our website at www.prestolite.com, or contact our technical service department at:

SERVICE PARTS LIST

GROUP: 17
FORM: 8AR

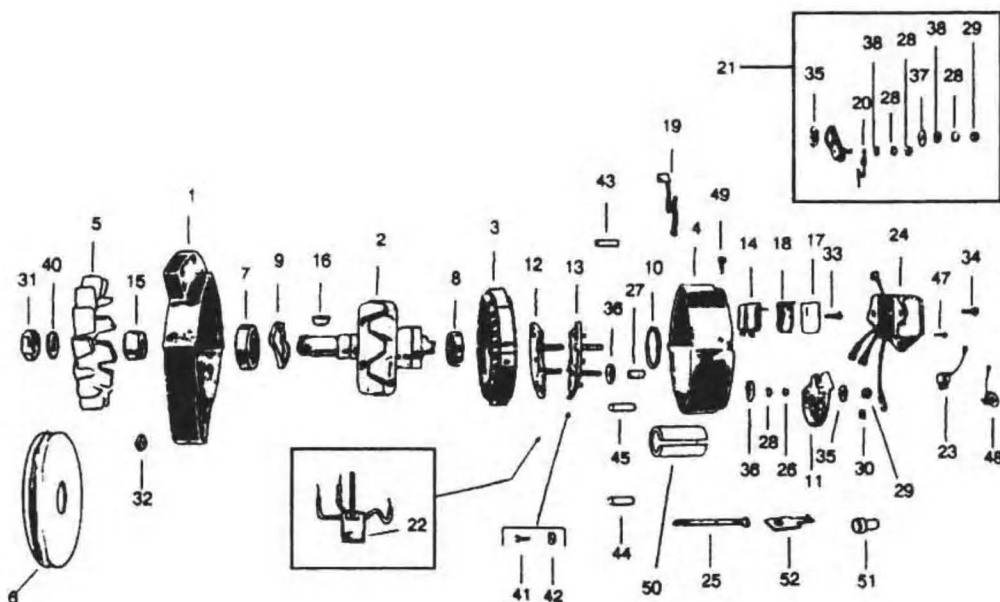

| MODEL NO. | SALES NO. | 13 DIODE REC. POS. | 14 BRUSH ASSEM | 15 SPACER FAN & PUL | 16 WDRFF KEY 5 | 17 COV. BRU HOLDER | 18 SHIELD DUST | 19 CABLE ASSEM | 20 CABLE, AC ASSEM | 21 AC TAP ASSEM | 22 DIODE TRIO | 23 | 24 VOLT. REG. |
|-----------|-----------|--------------------------|----------------------|---------------------------|----------------------|--------------------------|----------------------|----------------------|--------------------------|-----------------------|---------------------|----|---------------------|
| 8AR2001 | | 101-1 | 103-15 | 120-152 | 120-7 | 103-6 | 103-13 | | 116-58 | 102-17 | | | 105-151 |
| 8AR2002 | | 101-1 | 103-15 | 120-152 | 120-7 | 103-6 | 103-13 | | 116-58 | 102-17 | | | 105-151 |
| 8AR2004 | 110-100 | 101-1 | 103-15 | 120-152 | 120-7 | 103-6 | 103-13 | | | | | | 105-151 |
| 8AR2005 | | 101-1 | 103-15 | 120-152 | 120-7 | 103-6 | 103-13 | | | | | | 105-151 |
| 8AR2006 | | 101-1 | 103-15 | 120-152 | 120-7 | 103-6 | 103-13 | | | | | | 105-153 |
| 8AR2007 | 110-192 | 101-1 | 103-15 | 120-152 | 120-7 | 103-6 | 103-13 | | 116-58 | 102-17 | | | 105-151 |
| 8AR2008 | | 101-1 | 103-15 | 120-152 | 120-7 | 103-6 | 103-13 | | 116-58 | 102-17 | | | 105-151 |
| 8AR2009 | | 101-1 | 103-15 | 120-152 | 120-7 | 103-6 | 103-13 | | 116-58 | 102-17 | | | 105-151 |
| 8AR2012K | | 101-1 | 103-15 | 120-152 | 120-7 | 103-6 | 103-13 | | | | | | 105-153 |
| 8AR2013F | | 101-1 | 103-15 | 120-152 | 120-7 | 103-6 | 103-13 | | | | | | 105-153 |
| 8AR2013L | 110-476 | 101-98 | 103-46 | 120-375 | 120-7 | | | | | | 101-130 | | 105-307 |
| 8AR2014G | | 101-1 | 103-15 | 120-152 | 120-7 | 103-6 | 103-13 | | | | | | 105-151 |
| 8AR2015K | | 101-1 | 103-15 | 120-152 | 120-7 | 103-6 | 103-13 | | | | | | 105-151 |
| 8AR2016K | 110-147 | 101-1 | 103-15 | 120-152 | 120-7 | 103-6 | 103-13 | | 116-58 | 102-17 | | | 105-151 |
| 8AR2017F | | 101-1 | 103-15 | 120-152 | 120-7 | 103-6 | 103-13 | | | | | | 105-151 |
| 8AR2018F | 110-155 | 101-1 | 103-15 | 120-152 | 120-7 | 103-6 | 103-13 | | | | | | 105-151 |
| 8AR2019F | 110-146 | 101-1 | 103-15 | 120-152 | 120-7 | 103-6 | 103-13 | | | | | | 105-151 |
| 8AR2021K | 110-178 | 101-171 | 103-15 | 120-152 | 120-7 | 103-6 | 103-13 | | | 102-17 | 101-130 | | 105-152 |
| 8AR2022F | | 101-1 | 103-15 | 120-152 | 120-7 | 103-6 | 103-13 | | | | | | 105-151 |
| 8AR2023K | | 101-1 | 103-15 | 120-152 | 120-7 | 103-6 | 103-13 | | | | | | 105-151 |
| 8AR2024F | 110-161 | 101-1 | 103-15 | 120-152 | 120-7 | 103-6 | 103-13 | | | | | | 105-151 |
| 8AR2025K | 110-194 | 101-1 | 103-15 | 120-152 | 120-7 | 103-6 | 103-13 | | | | | | 105-153 |
| 8AR2026F | 110-177 | 101-171 | 103-15 | 120-152 | 120-7 | 103-6 | 103-13 | | | | | | 105-124 |
| 8AR2028F | | 101-171 | 103-15 | 120-152 | 120-7 | 103-6 | 103-13 | | | | 101-130 | | 105-152 |
| 8AR2033F | | 101-1 | 103-15 | 120-152 | 120-7 | 103-6 | 103-13 | | | | | | 105-151 |
| 8AR2037F | | 101-1 | 103-15 | 120-152 | 120-7 | 103-6 | 103-13 | | | | | | 105-151 |
| 8AR2041F | | 101-1 | 103-15 | 120-152 | 120-7 | 103-6 | 103-13 | | | | | | 105-151 |
| 8AR2043F | | 101-171 | 103-15 | 120-152 | 120-7 | 103-6 | 103-13 | | | | 101-130 | | 105-152 |

Important: The information contained in this bulletin is intended for use by trained, professional technicians who have the proper tools, equipment, and training to perform the required maintenance described above. This information is NOT intended for 'do-it-yourselfers', and you should not assume that this information applies to your equipment. If you have any questions regarding this information please visit our website at www.prestolite.com, or contact our technical service department at:

GROUP: 17
FORM: 8AR

| KEY NO. | SALES NO. | DESCRIPTION | 8AR2001 | 8AR2002 | 8AR2004 | 8AR2005 | 8AR2006 | 8AR2007 | 8AR2008 | 8AR2009 | 8AR2012K | 8AR2013F | 8AR2013L | 8AR2014G | 8AR2015K | 8AR2018K | 8AR2017F | 8AR2018F | 8AR2019F | 8AR2021K | 8AR2022F | 8AR2023K | 8AR2024F | 8AR2025K | 8AR2026F | 8AR2028F | 8AR2033F | 8AR2037F | 8AR2041F | 8AR2043F |
|---------|-----------|-----------------------------------|---------|---------|---------|---------|---------|---------|---------|---------|----------|----------|----------|----------|----------|----------|----------|----------|----------|----------|----------|----------|----------|----------|----------|----------|----------|----------|----------|----------|
| | | BOLTS | | | | | | | | | | | | | | | | | | | | | | | | | | | | |
| 25 | 120-1 | THROUGH, 10-32 x 2-55/64" | 4 | 4 | 4 | 4 | 4 | 4 | 4 | 4 | 4 | 4 | | | | | 4 | 4 | 4 | | 4 | | 4 | | 4 | 4 | 4 | 4 | 4 | 4 |
| 25 | 120-86 | THROUGH, 10-32 x 3-5/16" | | | | | | | | | | | 4 | | | | | | | | | | | | | | | | | |
| 25 | 120-143 | THROUGH, 10-32 x 3-1/8" | | | | | | 4 | | | 4 | | | 4 | 4 | 4 | | | | 4 | | 4 | | 4 | | | | | | |
| 41 | 120-93 | CARRIAGE, 10-24 x 1-1/2" | | | | | | | | | | | 1 | | | | | | | | | | | | | | | | | |
| | | NUTS | | | | | | | | | | | | | | | | | | | | | | | | | | | | |
| 28 | 120-34 | HEX, 10-24 | 3 | 3 | 3 | 3 | 3 | 3 | 3 | 3 | 3 | 3 | | 3 | 3 | 3 | 3 | 3 | 3 | 3 | 3 | 3 | 3 | 3 | 3 | 3 | 3 | 3 | 3 | 3 |
| 28 | 120-95 | HEX, 10-24 x 3/8" | | | | | | | | | | | 2 | | | | | | | | | | | | | | | | | |
| 29 | 120-272 | HEX, LOCK 10-24 | 4 | 4 | 4 | 4 | 4 | 4 | 4 | 4 | 4 | 4 | | 4 | 4 | 4 | 4 | 4 | 4 | 4 | 4 | 4 | 4 | 4 | 4 | 4 | 4 | 4 | 4 | 4 |
| 30 | 120-342 | HEX, 1/4-20 x 7/16" CONE LOCK | 1 | 1 | 1 | 1 | 1 | 1 | 1 | 1 | 1 | 1 | 2 | 1 | 1 | 1 | 1 | 1 | 1 | 1 | 2 | 1 | 1 | 1 | 1 | 1 | 2 | 1 | 1 | 1 |
| 31 | 120-136 | PULLEY MOUNTING, 5/8-18 | 1 | 1 | 1 | 1 | 1 | 1 | 1 | 1 | 1 | 1 | 1 | 1 | 1 | 1 | 1 | 1 | 1 | 1 | 1 | 1 | 1 | 1 | 1 | 1 | 1 | 1 | 1 | 1 |
| 32 | 120-150 | SQUARE, 10-32 | 4 | 4 | 4 | 4 | 4 | 4 | 4 | 4 | 4 | 4 | | 4 | 4 | 4 | 4 | 4 | 4 | 4 | 4 | 4 | 4 | 4 | 4 | 4 | 4 | 4 | 4 | 4 |
| 32 | 120-376 | HEX, 10-24 x 1/8TK | | | | | | | | | | | 5 | | | | | | | | | | | | | | | | | |
| | | SCREWS | | | | | | | | | | | | | | | | | | | | | | | | | | | | |
| 33 | 120-102 | TAPPING, 8-32 x 1/2" | 2 | 2 | 2 | 2 | 2 | 2 | 2 | 2 | 2 | 2 | 4 | 2 | 2 | 2 | 2 | 2 | 2 | 2 | 2 | 2 | 2 | 2 | 2 | 2 | 2 | 2 | 2 | 2 |
| 34 | 120-223 | TAPPING, 10-24 x 5/8" | 2 | 2 | 2 | 2 | 2 | 2 | 2 | 2 | 2 | 2 | | 2 | 2 | 2 | 2 | 2 | 2 | 2 | 2 | 2 | 2 | 2 | 2 | 2 | 2 | 2 | 2 | 2 |
| 47 | 120-234 | TAPPING, 10-24 x 3/8" | 1 | 1 | 1 | 1 | 1 | 1 | 1 | 1 | 1 | 1 | | 1 | 1 | 1 | 1 | 1 | 1 | 1 | 1 | 1 | 1 | 1 | 1 | 1 | 1 | 1 | 1 | 1 |
| 49 | 120-208 | TAPPING, 4-40 x 3/16" | 2 | 2 | 2 | 2 | 2 | 2 | 2 | 2 | 2 | 2 | | 2 | 2 | 2 | 2 | 2 | 2 | 2 | 2 | 2 | 2 | 2 | 2 | 2 | 2 | 2 | 2 | 2 |
| 49 | 120-381 | TAPPING, 4-40 x 7/32" | | | | | | | | | | | 1 | | | | | | | | | | | | | | | | | |
| | | WASHERS | | | | | | | | | | | | | | | | | | | | | | | | | | | | |
| 35 | 115-4 | INSULATOR, NO. 10 x 1/2" | 1 | 1 | 1 | 1 | 1 | 1 | 1 | 1 | 1 | 1 | | 1 | 1 | 1 | 1 | 1 | 1 | 1 | 1 | 1 | 1 | 1 | 1 | 1 | 1 | 1 | 1 | 1 |
| 35 | 115-51 | INSULATOR, NO. 10 | | | | | | | | | | | 4 | | | | | | | | | | | | | | | | | |
| 36 | 115-3 | INSULATOR, NO. 10 x 3/4" | 5 | 5 | 5 | 5 | 5 | 5 | 5 | 5 | 5 | 5 | 2 | 5 | 5 | 5 | 5 | 5 | 5 | 4 | 5 | 5 | 5 | 5 | 5 | 4 | 5 | 5 | 5 | 4 |
| 36 | 115-10 | INSULATOR, 1/4" STUD X 3/4" | | | | | | | | | | | | | | | | | | 2 | | | | | | | 2 | | | 2 |
| 36 | 115-54 | INSULATOR, 1/4" STUD | | | | | | | | | | | 2 | | | | | | | | | | | | | | | | | |
| 37 | 120-109 | FLAT METAL, 1/4" STUD x 9/16" | | | | | | | | | | | 1 | | | | | | | 1 | | | | | | 1 | | | 1 | |
| 37 | 120-120 | FLAT METAL, NO. 10 | 3 | 3 | 3 | 3 | 3 | 3 | 3 | 3 | 3 | 3 | 2 | 3 | 3 | 3 | 3 | 3 | 3 | 3 | 3 | 3 | 3 | 3 | 3 | 3 | 3 | 3 | 3 | 3 |
| 38 | 120-111 | SPLIT LOCK, NO. 10 | 3 | 3 | 3 | 3 | 3 | 3 | 3 | 3 | 3 | 3 | | 3 | 3 | 3 | 3 | 3 | 3 | 3 | 3 | 3 | 3 | 3 | 3 | 3 | 3 | 3 | 3 | 3 |
| 38 | 120-378 | FLAT METAL, .203ID x .500D | | | | | | | | | | | 5 | | | | | | | | | | | | | | | | | |
| 40 | 120-137 | SPLIT LOCK, 5/8" | 1 | 1 | 1 | 1 | 1 | 1 | 1 | 1 | 1 | 1 | 1 | 1 | 1 | 1 | 1 | 1 | 1 | 1 | 1 | 1 | 1 | 1 | 1 | 1 | 1 | 1 | 1 | 1 |
| | | MISC. | | | | | | | | | | | | | | | | | | | | | | | | | | | | |
| 26 | 115-2 | INSULATOR, SLEEVE NO. 10 x 3/32" | 1 | 1 | 1 | 1 | 1 | 1 | 1 | 1 | 1 | 1 | | 1 | 1 | 1 | 1 | 1 | 1 | 1 | 1 | 1 | 1 | 1 | 1 | 1 | 1 | 1 | 1 | 1 |
| 27 | 115-1 | INSULATOR, SLEEVE NO. 10 x 19/32" | 2 | 2 | 2 | 2 | 2 | 2 | 2 | 2 | 2 | 2 | | 2 | 2 | 2 | 2 | 2 | 2 | 2 | 2 | 2 | 2 | 2 | 2 | 2 | 2 | 2 | 2 | 2 |
| 42 | 115-7 | INSULATOR, SQ. NO. 10ID, 5/8OD | | | | | | | | | | | 1 | | | | | | | | | | | | | | | | | |
| 44 | 115-26 | INSULATOR, SLEEVE 1/4" ID x 1/2" | | | | | | | | | | | 1 | | | | | | 1 | | | | | | | 1 | | | 1 | |
| 45 | 115-27 | INSULATOR, SLEEVE NO. 10 x 1/3" | | | | | | | | | | | 2 | | | | | | 1 | | | | | | | 1 | | | 1 | |
| 46 | 115-56 | SPACER BUSHING | | | | | | | | | | | | | | | | | 4 | | | | | | | 4 | | | 4 | |
| 51 | 120-287 | CAP, STUD | | | | | | | | | | | 1 | | | | | | | | | | | | | | | | | |

Important: The information contained in this bulletin is intended for use by trained, professional technicians who have the proper tools, equipment, and training to perform the required maintenance described above. This information is NOT intended for 'do-it-yourselfers', and you should not assume that this information applies to your equipment. If you have any questions regarding this information please visit our website at www.prestolite.com, or contact our technical service department at: